

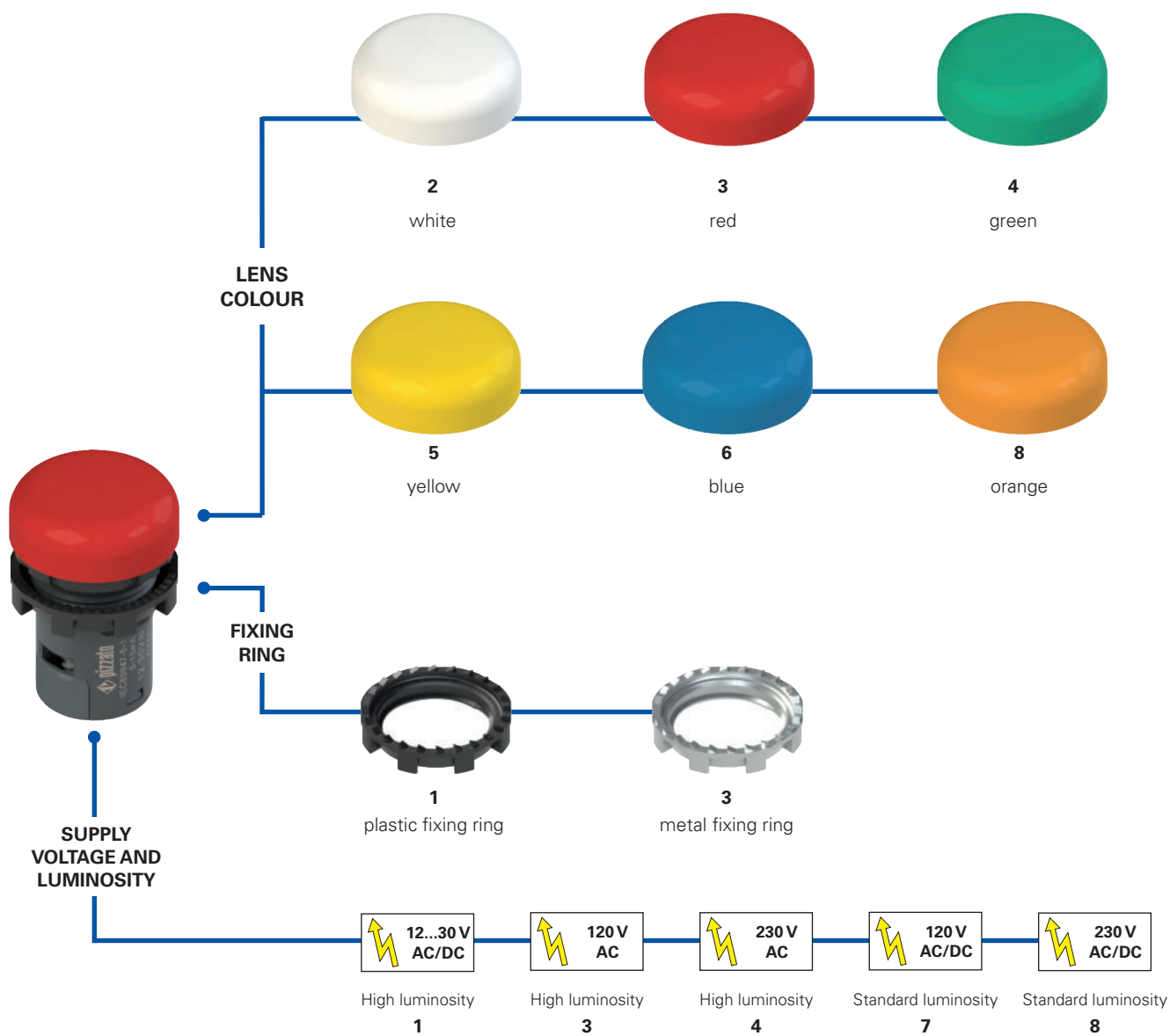

Selection diagram



Code structure **Attention!** The feasibility of a code number does not mean the effective availability of a product. Please contact our sales office.

E6 1IL1A2110

Fixing ring and shaped ring	
1	plastic fixing ring (standard)
2	plastic fixing ring and shaped ring
3	metal fixing ring
4	metal fixing ring and shaped ring

Engraving	
0	no engraving (standard)
IT7	IN SERVIZIO
L54	
...

Other engravings on request. See page 159.

Supply voltage	
1	12 ... 30 Vac/dc high luminosity
3	120 Vac high luminosity
4	230 Vac high luminosity
7	120 Vac/dc standard luminosity
8	230 Vac/dc standard luminosity

Lens colour	
2	white
3	red
4	green
5	yellow
6	blue
8	orange



Main features

- Fully integrated indicator light in monolithic body
- Protection degrees IP67 and IP69K
- Three supply voltages:
12 ... 30 Vac/dc, 120 Vac/dc, 230 Vac/dc
- Customisation with symbols available

Quality marks:



UL approval: E131787
EAC approval: RU C-IT.YT03.B.00035/19

Technical data

General data

Protection degree:	IP67 acc. to EN 60529 IP69K acc. to ISO 20653 (with shaped ring VE GP12H1A or label holder VE PT32A00A0)
Ambient temperature:	-40°C ... +70°C
Endurance:	Min. 50,000 hours (at rated voltage and +25 °C ambient temperature)
Tightening torque of the terminal screws:	0.8 ... 1 Nm
Tightening torque of the fixing ring:	2 ... 2.5 Nm
Utilization requirements:	See page 163

LED units

Operating voltages and currents (high luminosity versions):
12 ... 30 Vac/dc; 5 ... 15 mA
102 ... 138 Vac; 20 mA max.
195 ... 264 Vac; 20 mA max.

Operating voltages and currents (standard luminosity versions):
102 ... 138 Vac/dc; 2.5 mA
195 ... 264 Vac/dc; 2.5 mA

Cable cross section:
min 1 x 0.34 mm² (1 x AWG 22)
max. 2 x 1.5 mm² (2 x AWG 16)

Cable stripping length (x):
6 mm

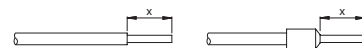

In compliance with standards:

IEC 60947-1, IEC 60947-5-1, IEC 60204-1, EN 60947-1, EN 60947-5-1, EN 60204-1, EN IEC 63000, UL 508, CSA 22-2 No. 14.

Compliance with the requirements of:

Low Voltage Directive 2014/35/EU,
EMC Directive 2014/30/EU,
RoHS Directive 2011/65/EU.

Features approved by UL

For Use on a Flat Surface of a Type 1, 4X, 12 and 13
Pollution degree 2
Overvoltage category 3
Wire range 16-22 AWG
The tightening torque of the Terminals Block is 0.8-1.0 Nm

General data

Protection degrees IP67 and IP69K

IP69K
IP67

These devices are designed to be used in the toughest environmental conditions and they pass the IP67 immersion test acc. to EN 60529. They can therefore be used in all environments where maximum protection degree of the housing is required. Due to their special design, these devices are suitable for use in equipment subjected to cleaning with high pressure hot water jets. These devices meet the IP69K test requirements according to ISO 20653 (water jets with 100 bar and 80°C).

Integrated screw connection

The shape of the type E6 indicator light, though very compact, allows the integration on the device of all components for proper installation and functioning. All that is required is to wire the device by means of its screw terminals in a quick and intuitive way. There is no need to install further components.

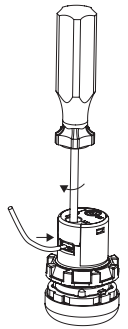

Metal fixing ring



The fixing ring in metal is particularly suitable for those applications which require tighter fitting of the panel-mounted device, such as for example in metal panels having holes without reference notches.



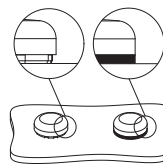



Shaped ring



The shaped ring can be used when no label holder or other devices are applied; it prevents dirt and other residues from settling between the indicator and the panel or housing. This turns out to be particularly useful in the sectors where high standards of cleanness and hygiene are required.

Selection table

Packs of **10 pcs.**

Colour	Operating voltage				
	12 - 30 Vac/dc High luminosity	120 Vac High luminosity	230 Vac High luminosity	120 Vac/dc Standard luminosity	230 Vac/dc Standard luminosity
 white	E6 1IL1A2110	E6 1IL3A2110	E6 1IL4A2110	E6 1IL7A2110	E6 1IL8A2110
 red	E6 1IL1A3110	E6 1IL3A3110	E6 1IL4A3110	E6 1IL7A3110	E6 1IL8A3110
 green	E6 1IL1A4110	E6 1IL3A4110	E6 1IL4A4110	E6 1IL7A4110	E6 1IL8A4110
 yellow	E6 1IL1A5110	E6 1IL3A5110	E6 1IL4A5110	E6 1IL7A5110	E6 1IL8A5110
 blue	E6 1IL1A6110	E6 1IL3A6110	E6 1IL4A6110	E6 1IL7A6110	E6 1IL8A6110
 orange	E6 1IL1A8110	E6 1IL3A8110	E6 1IL4A8110	E6 1IL7A8110	E6 1IL8A8110

Dimensions

All values in the drawings are in mm

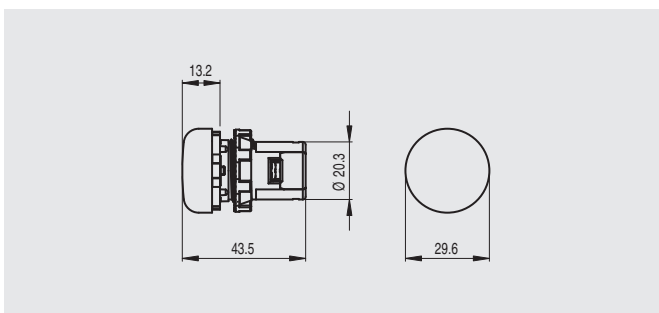

Minimum distances for installation

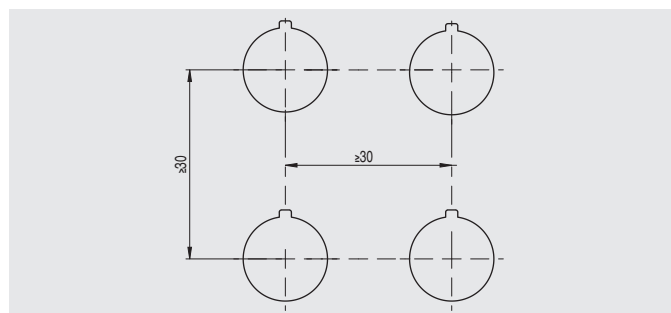

→ The 2D and 3D files are available at www.pizzato.com